

Palmyra Township, Wayne County, Pennsylvania Zoning Map

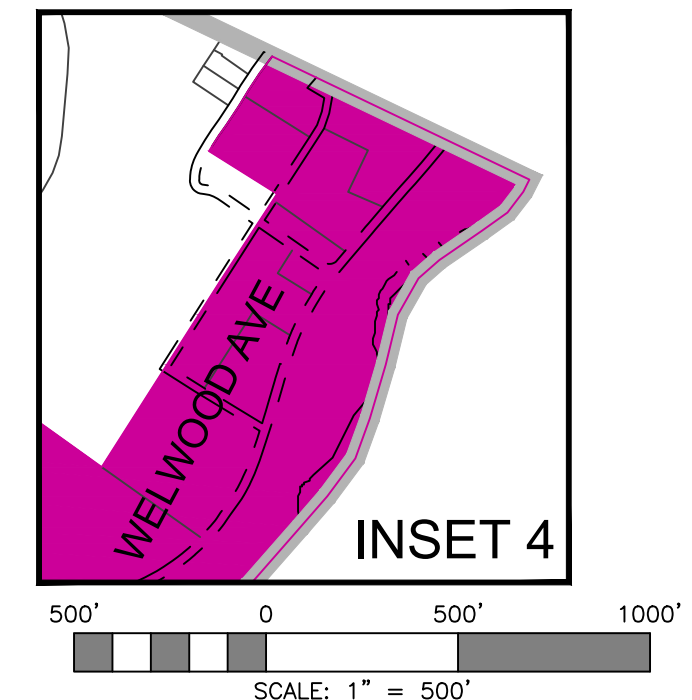
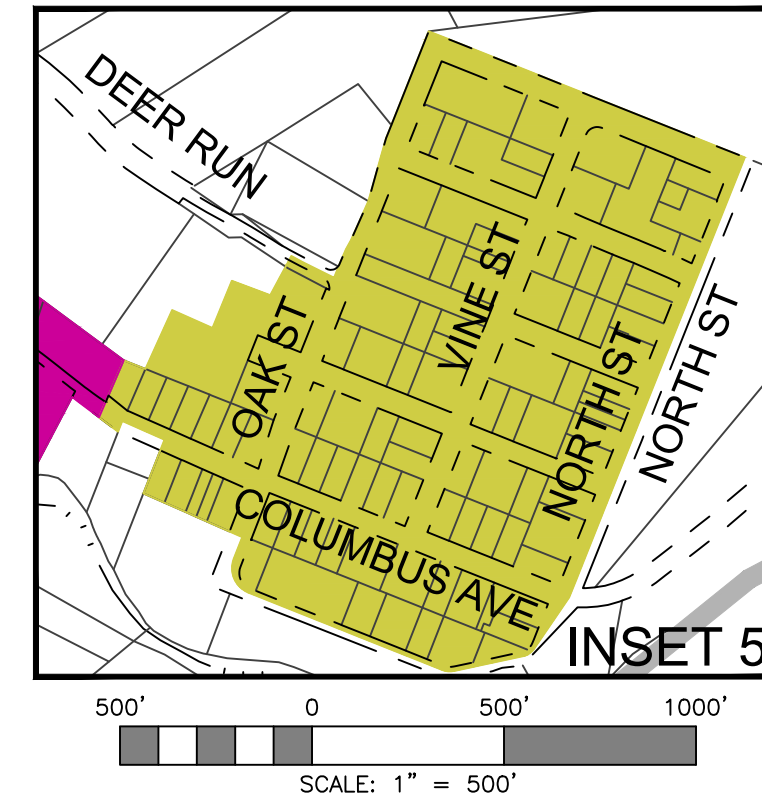
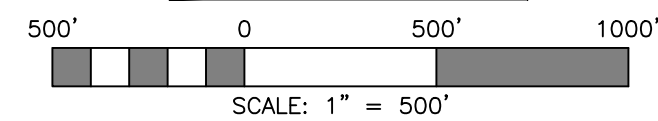
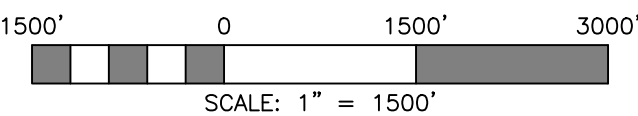
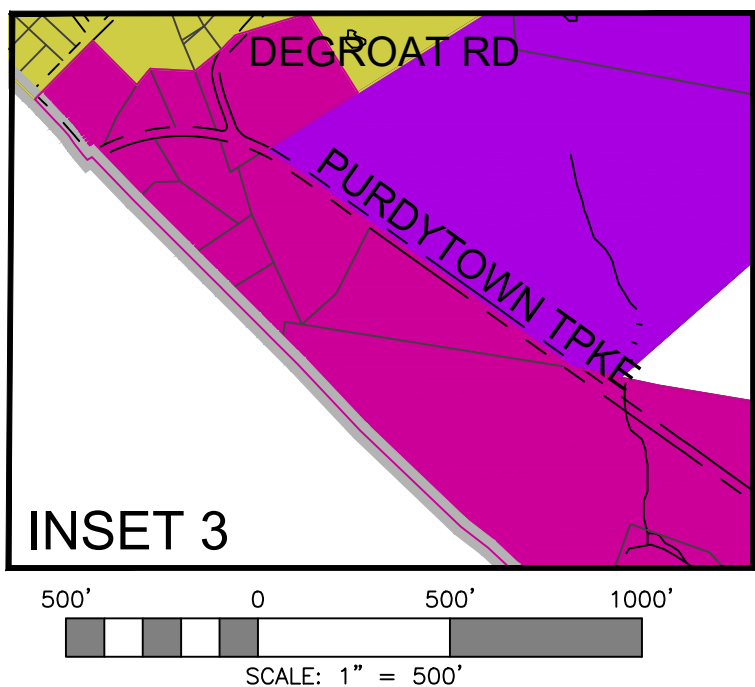
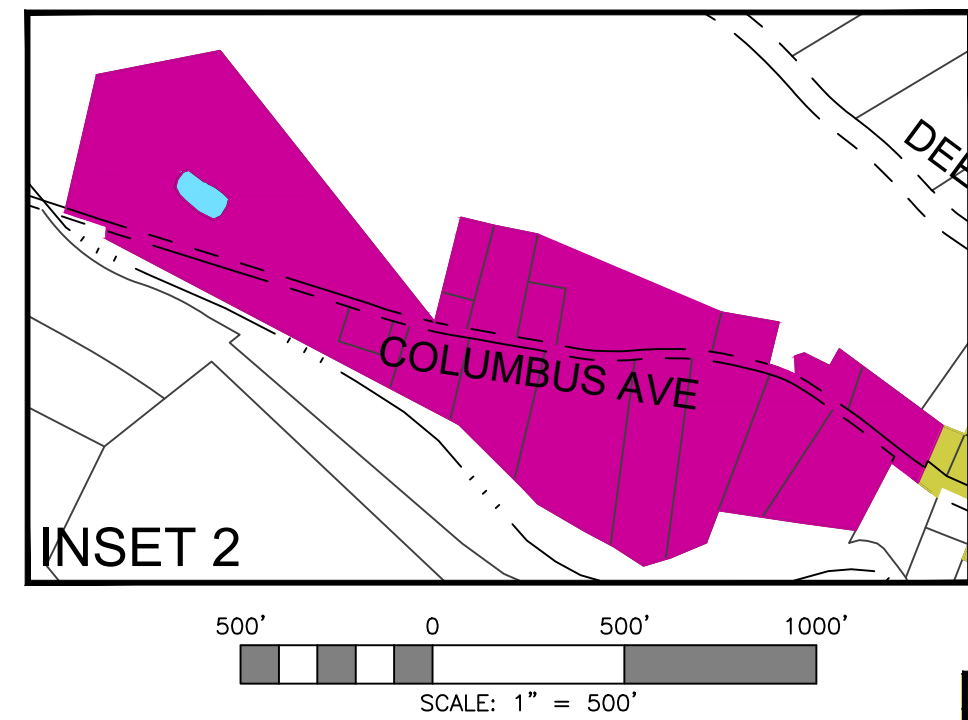
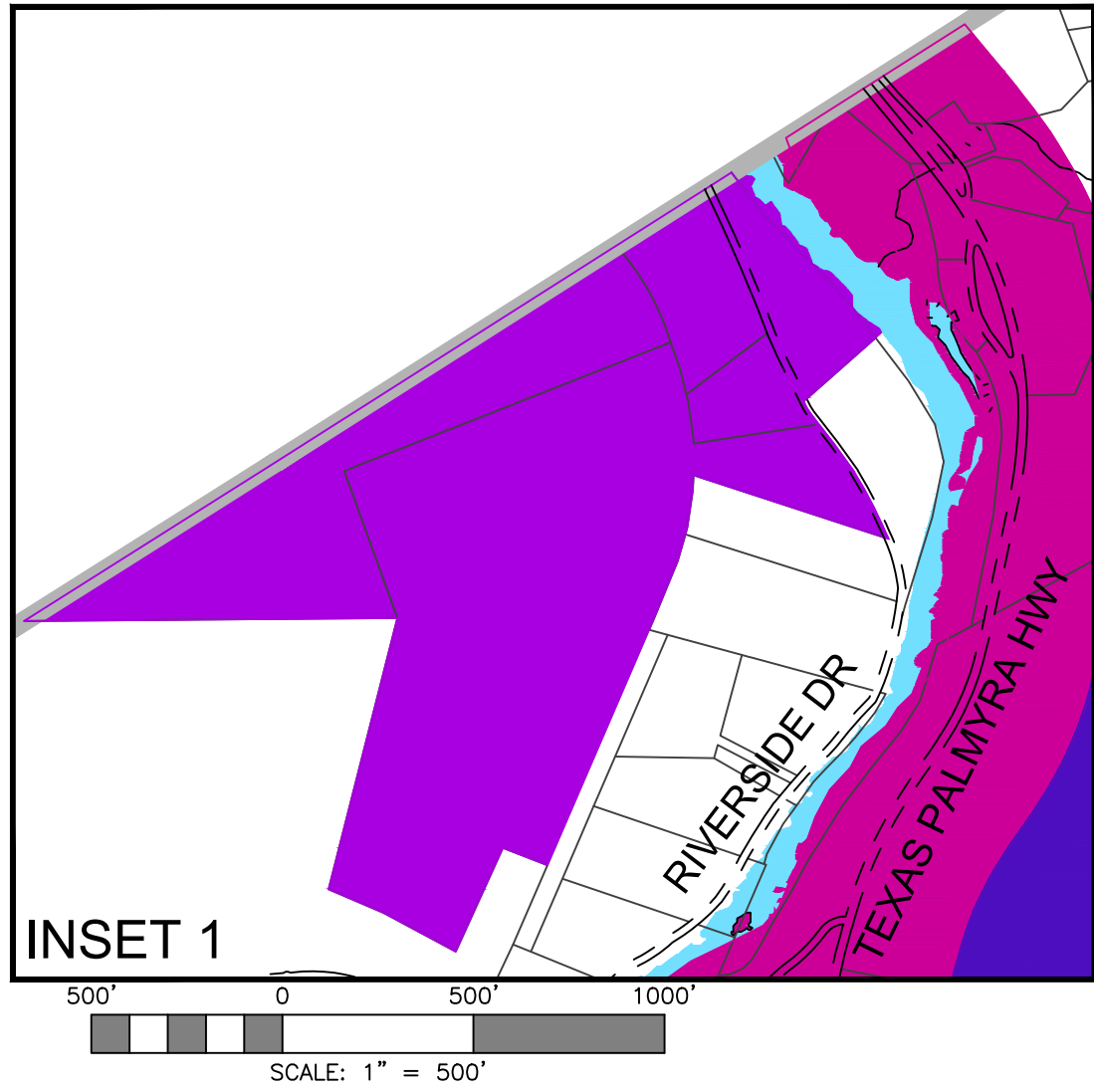

- Township Boundary
- Roads
- Tax Parcels
- Water Bodies
- Water Courses
- Cherry Ridge Airport Surface Area*
- Zoning Districts
- C-1 General Commercial
 - C-2 Resort Commercial
 - I-1 Industrial
 - R-1 Low Density Residential
 - R-R Rural Residential

* Part of the airport hazard area, defined by the Pennsylvania Department of Transportation, for Cherry Ridge Airport that falls within the planning area.

Palmyra Township Official Zoning Map 2023

Adopted in accord with the Pennsylvania Municipalities Planning Code this th day of , 2023, at a dully convened meeting of the Palmyra Township Supervisors, Wayne County, Pennsylvania.

Chairman

Vice Chairman

Supervisor

Attest

Secretary

Palmyra Township, Wayne County, Pennsylvania Zoning Map

Prepared for the Palmyra Township Supervisors.
Prepared by Kiley Associates April, 2023

240 Main Avenue, Lower Level
Po Box 317, Hawley, PA 18428 570-226-5810



THIS ZONING DISTRICT MAP IS FOR GENERAL PURPOSES ONLY. THE OFFICIAL ZONING MAP OF PALMYRA TOWNSHIP IS ON FILE AT THE TOWNSHIP BUILDING AND WILL BE USED TO MAKE THE FINAL DETERMINATION OF ALL ZONING DISTRICT BOUNDARIES IN ACCORDANCE WITH THE PALMYRA TOWNSHIP ZONING ORDINANCE.

BASE MAPPING DATA COURTESY OF WAYNE COUNTY GIS-MAPPING DEPT.

NOTE 1: INDUSTRIAL ZONE ON TAX MAP # 10-0-0285-0001 SHOWN AS PER PLAN BY KILEY SURVEYING AND MAPPING, TITLED "PROPOSED QUARRY IN INDUSTRIAL ZONE ON LANDS OF MALTI, MALTI, & GOODWIN, DATED 6-18-02 AND RECORDED IN WAYNE COUNTY MAP BOOK 135 PAGE 99. A COPY OF THE MAP IS ON FILE AT THE PALMYRA TOWNSHIP BUILDING.